

REV.	DESCRIPTION	ECN NO.	DATE	DRAWER
A	New Release		09/02/2005	Kelly

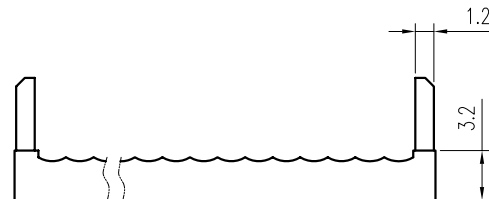
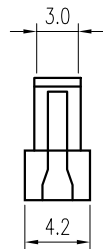
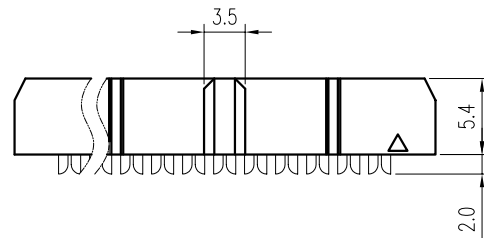
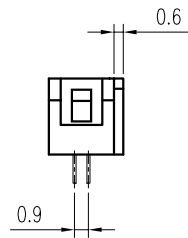
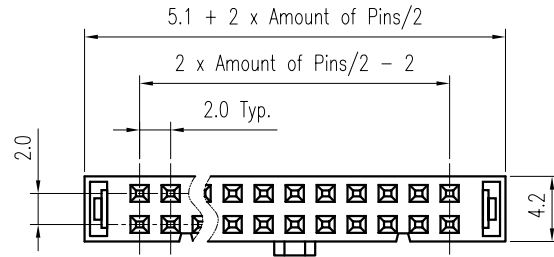
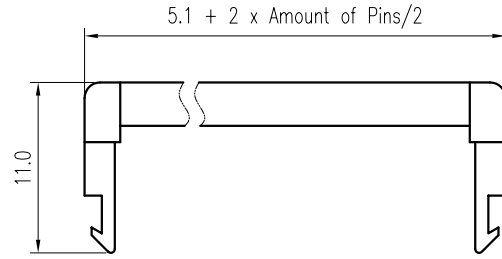
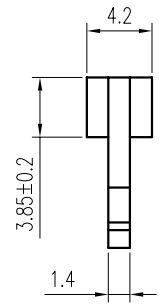

Notes:

- Material :  
Housing : Thermoplastic UL 94V-0  
Terminal : Copper Alloy
- Finish :  
Terminal : Selected Gold on Contact Area  
80u" Min. Tin on Solder Tail
- Order Information :

X I90-1022 X - XX Y X

Z: RoHS(for High Temperature)  
Y: RoHS  
Blank: Unsuitable RoHS

Part Option:

- 2 Subassembly
- 3 Subassembly

Amount of Pins:

- 04 : 4 Pins  
s  
68 : 68 Pins

Plating Option:

- A: G/F on Contact Area  
H: 30u" Min. Gold on Contact Area

DIMENSION IN mm [inch]	
Tolerance unless otherwise specified	
X. ± 0.38	X.* ± 10'
X.X ± 0.25	X.X' ± 5'
X.XX ± 0.13	X.XX' ± 2'
X.XXX ±	X.XXX' ±

**CEN** 欣訊科技股份有限公司  
CEN LINK CO., LTD.  
CUSTOMER DRAWING

Title	2.0mm Pitch IDC Socket	
Dwg No.	XI90-1022X-XXYX	
File No.		Scale: 2 : 1
Apprver:	Checker:	Size: A 4
Drawer: Kelly_*	09/02/2005	Rev : A
		Sheet: 1 / 1