

REV.	DESCRIPTION	ECN NO.	DATE	DRAWER
A	New Release		09/02/2005	Tom

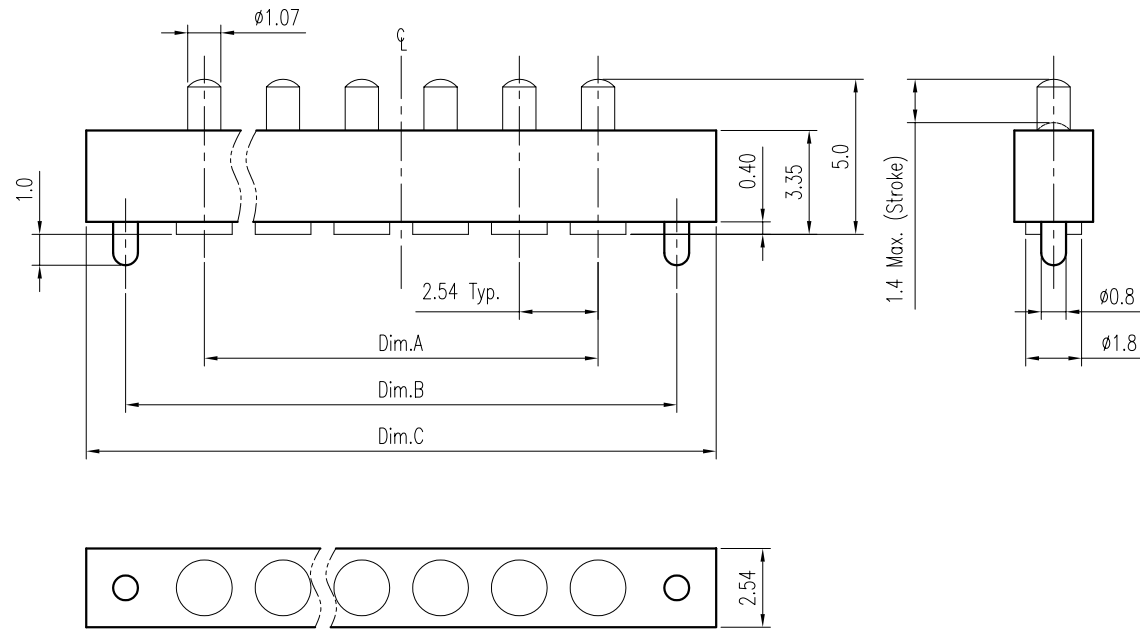

Notes:

- Material :
Housing : Thermoplastic UL 94V-0, Black
Terminal : Copper Alloy
- Finish :
Terminal : 20u" Gold on Contact Area, 10u" Gold on Solder Tails, Both over 100u" Ni Under-plated Overall
- Spring Pin Force : 0.6N ± 0.15N at Stroke 0.7mm
- Order Information :
TPE1-011 X 4-02T1

Amount of Pins
2 : 2 Pins
?
9 : 9 Pins
A : 10 Pins
?
G : 16 Pins

Dimension Information:

Part No.	Dim.	Dim.A	Dim.B	Dim.C
TPE1-01124-02T1	2.54	7.62	10.16	
TPE1-01134-02T1	5.08	10.16	12.70	
TPE1-01144-02T1	7.62	12.70	15.24	
TPE1-01154-02T1	10.16	15.24	17.78	
TPE1-01164-02T1	12.70	17.78	20.32	
TPE1-01174-02T1	15.24	20.32	22.86	
TPE1-01184-02T1	17.78	22.86	25.40	
TPE1-01194-02T1	20.32	25.40	27.94	
TPE1-011A4-02T1	22.86	27.94	30.48	
TPE1-011B4-02T1	25.40	30.48	33.02	
TPE1-011C4-02T1	27.94	33.02	35.56	
TPE1-011D4-02T1	30.48	35.56	38.10	
TPE1-011E4-02T1	33.02	38.10	40.64	
TPE1-011F4-02T1	35.56	40.64	43.18	
TPE1-011G4-02T1	38.10	43.18	45.72	

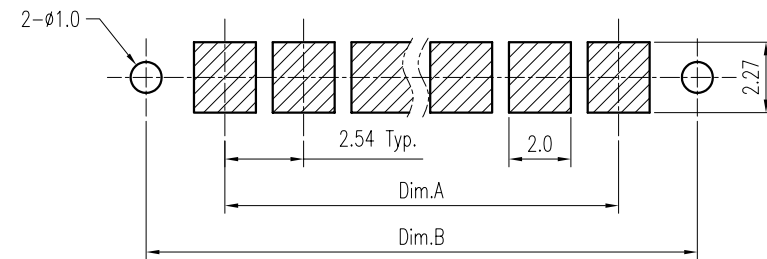

Recommended P.C.B. Layout
Layout Tolerance = ± 0.05 mm

DIMENSION IN mm [inch]		 欣訊科技股份有限公司 CEN LINK CO., LTD. CUSTOMER DRAWING	Title 2.54mm Pitch Pin Header Spring Pin Conn.		 Scale: 4 : 1
Tolerance unless otherwise specified			Dwg No. TPE1-011X4-02T1		
X. ± 0.38	X.* ± 10'	File No.		Rev : A	
X.X ± 0.25	X.X* ± 5'	Apprver:		Sheet: 1 / 1	
X.XX ± 0.20	X.XX* ± 2'	Checker:		Drawer: Tom	
X.XXX ±	X.XXX* ±			09/02/2005	